

# // SCP CENTRE

158 Cook Street, Meaford, ON



**Building Size:** 174,000 sf (Office: 14,000sf over 2 floors, Industrial: 160,000sf).

**Availability:** Flexible options (Office: 14,000sf, Flex: 86,000sf).

**Rental structure:** Please contact.

**Clear Height:** Ranges from 10' to 23'.

**Access:** 5 loading docks, 3 drive in doors.



For more information please contact:

**Kevin Duffy**  
Broker of Record  
416-903-6637

**Justin Dougherty**  
Sales Representative  
416-399-1913

[duffygroup.ca](http://duffygroup.ca)



### Comments:

Purpose built office/industrial style campus.

New building upgrades underway.

Spread out over multiple connected buildings.  
Massive block of creative, contiguous space.

Conforms to plethora of uses (office, industrial, retail and residential).

Connect further to discuss property investment opportunity (over 8 acres total).

## SCP CENTRE

158 Cook Street, Meaford, ON

SCP Centre Plan View

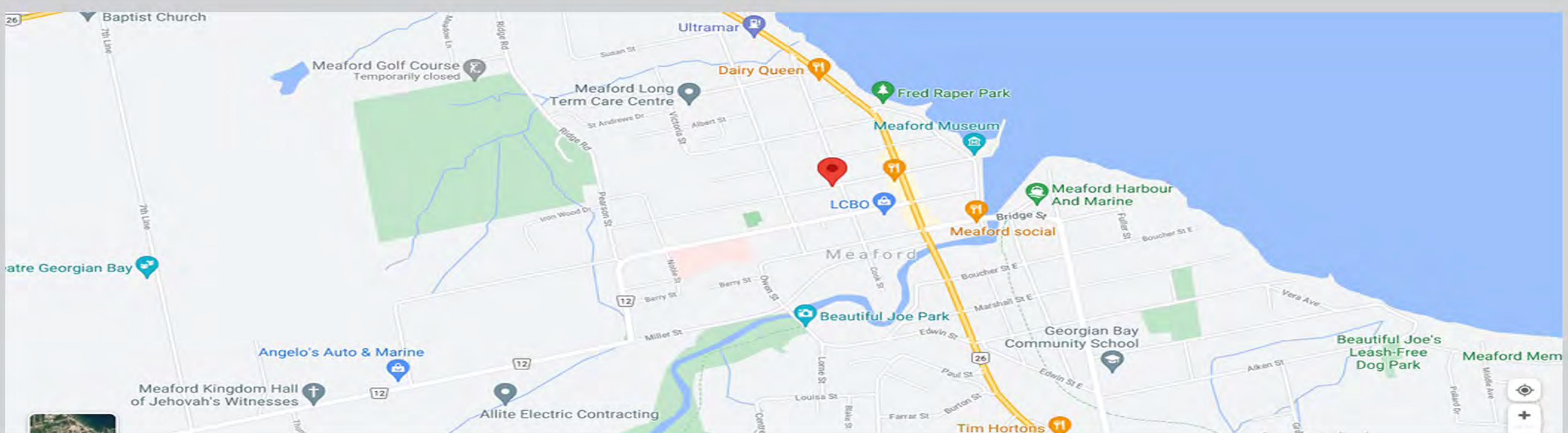
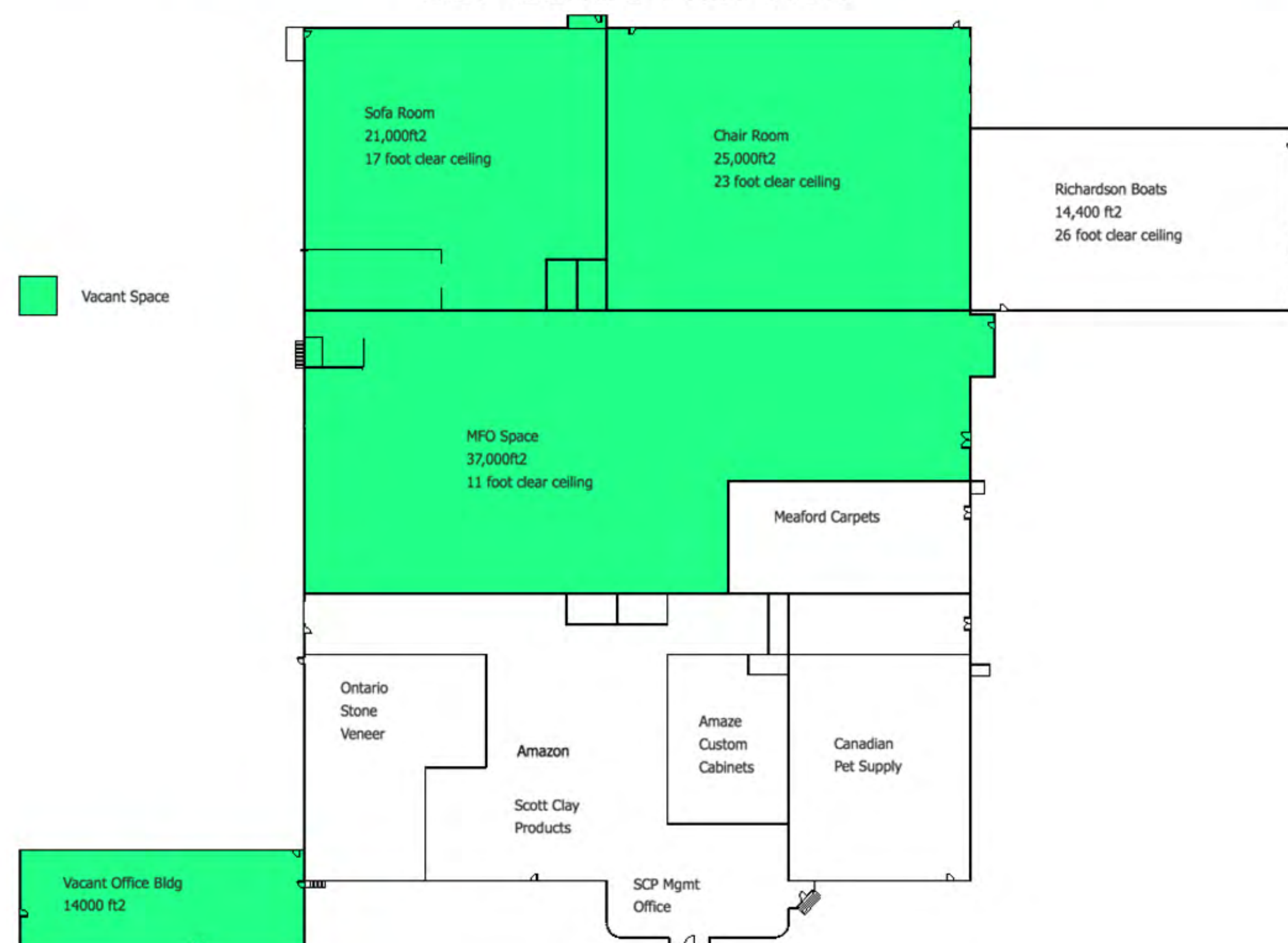

**DUFFY**  
— GROUP —

**Kevin Duffy\*\*** [kduffy@duffygroup.ca](mailto:kduffy@duffygroup.ca) | 416.903.6637

**Justin Dougherty\*** [jdougherty@duffygroup.ca](mailto:jdougherty@duffygroup.ca) | 416-399-1913

Duffy & Associates Real Estate Services Inc.  
111 Queen St. E, - Suite 450. M5C 1S2 Toronto ON

[duffygroup.ca](http://duffygroup.ca) Office: 416.477.8249 Fax: 647.256.3501